

Hogies ProPac & MediView

# Instructions

Hogies MiniScope and MediView frame instruction leaflet



Hogies MiniScope Loupes and MediView offer you high quality, precision optics designed by Martin Hogan PTY optometrists based in Melbourne, Australia. Hogies MediView won the Australian Design award.

**HOGIES**™ **EYEGUARD**

This leaflet will help you through the assembly of your new loupes

## Checklist

1. 1 x Hogies MediView Frame
2. 1 x Pair of Hogies MiniScope loupes with hinge. (Only supplied in Hogies ProPac)
3. 1 x Nose Bridge
4. 1 x Hogies Neck Cord
5. 1 x Clear Polycarbonate eye shield
6. 1 x Clear Magnetised eye shield, for use without loupe.
7. 1 x Pen screwdriver

Please note if you have purchased your Hogies MediView for the use with another make of loupes, then you will require a hinge to mount them onto the MediView frame.



## Step 1

Parts required No.1 (MediView frame) and No.5 (Clear Polycarbonate eye shield)  
Take the MediView frame (1) and the Clear Polycarbonate eye shield (5) and locate the small holes on the shield with the dowels on the frame as arrowed.

## Step 2

Parts required Assembly from step 1  
With one hand holding the MediView frame and the other holding the MiniScope loupes guide the magnet on the hinge towards magnet located on the frame. Ensure that the locating pin (arrowed) on the frame lines up with the locating hole on the hinge assembly. The powerful magnet will self seek the hinge on to the frame so just make a precautionary check that the hinge has located on to the dowel and holds the shield in place.



### Step 3

The nose bridge is already attached to the frame. Ensure that the two parts are located together as shown. The bridge can be adjusted for height and comfort. You will find that the bridge is very flexible and can be bent in any position to suit you.

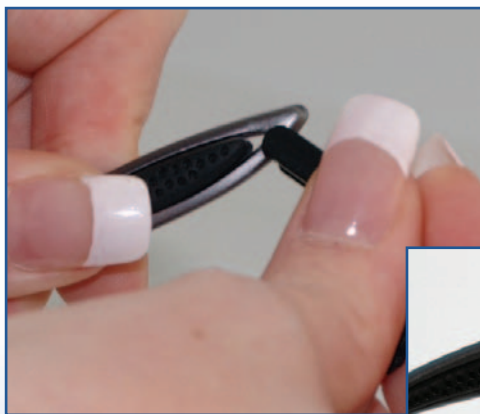
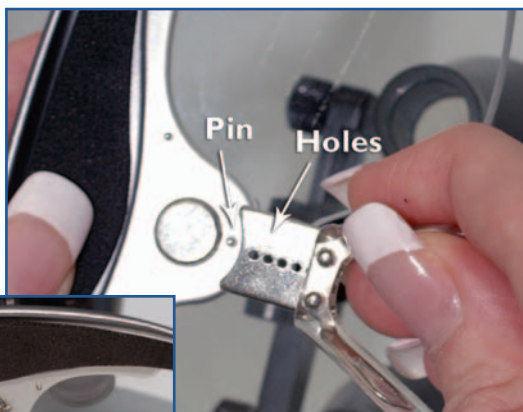

### Step 4

Parts required are assembly from step 3 and part No 4. At the end of the arm on either side there is a hole, with the neck cord there is a connection clip. Snap the connector in to the hole. The assembly is now finished.



### MiniScope Loupe adjustment

To adjust your loupe, angle the hinge for comfort and clarity. If two images are seen through your loupe adjust the centre knob only. This will move the loupe yoke to centre your image seen through the lenses.

### Cleaning your MiniScope loupes

To clean your loupes use only a non-alcohol wipe. Do not soak or autoclave. To clean the lens blow any dust or debris off with a jet of air from your three in one syringe if available. Carefully wipe the lens with a lens cloth.

**BLACKWELL**  
**B** Supplies  
A  HENRY SCHEIN® COMPANY

Manufactured by Martin Hogan PTY Ltd.

Designer Eyewear

14 Collins Street

Melbourne 3000

Australia

hhogan@netspace.net.au [www.hogies.com](http://www.hogies.com)

Distributed by Blackwell Supplies,

A division of Henry Schein Ltd.,

Medcare House,

Centurion Close,

Gillingham,

Kent, ME8 0SB

Tel: 01634 877620 Fax: 01634 877621